

### UNM由任90° UNM TYPE

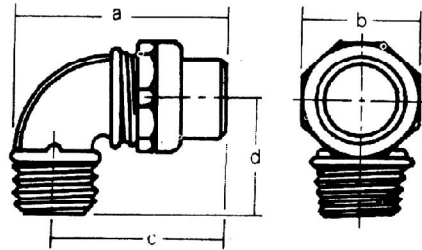
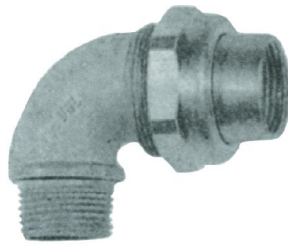

單位：mm

Cat No 目錄型號	UNM01	UNM02	UNM03	UNM04	UNM05	UNM06	UNM07	UNM08	UNM09	Cast Iron 鑄鐵
	UNM01-M	UNM02-M	UNM03-M	UNM04-M	UNM05-M	UNM06-M	UNM07-M	UNM08-M	UNM09-M	DACKTYL 展性鑄鐵
CONDUITSIZE 公稱管徑	Pt 1/2" NPT (16)	Pt 3/4" NPT (22)	Pt 1" NPT (28)	Pt 1 1/4" NPT (36)	Pt 1 1/2" NPT (42)	Pt 2" NPT (54)	Pt 2 1/2" NPT (70)	Pt 3" NPT (82)	Pt 4" NPT (104)	表面處理 Standard Fimistrs
A	48	68								電鍍鋅 Zinc Electroplate
B	35	41								
C	52	57								

### 電纜出線接頭 CGB TYPE

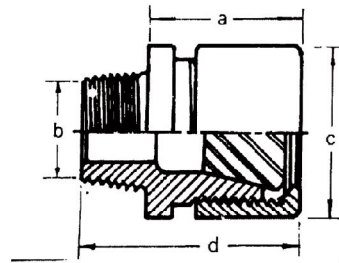
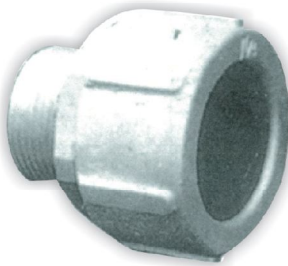

單位：mm

Cat No 目錄型號	CGB01	CGB02	CGB03	CGB04	CGB05	CGB06	CGB07	CGB08	CGB09	Cast Iron 鑄鐵
	CGB01-M	CGB02-M	CGB03-M	CGB04-M	CGB05-M	CGB06-M	CGB07-M	CGB08-M	CGB09-M	DACKTYL 展性鑄鐵
	CGB01-A	CGB02-A	CGB03-A	CGB04-A	CGB05-A	CGB06-A	CGB07-A	CGB08-A	CGB09-A	Aluminum 鋁合金
CONDUITSIZE 公稱管徑	Pt 1/2" NPT (16)	Pt 3/4" NPT (22)	Pt 1" NPT (28)	Pt 1 1/4" NPT (36)	Pt 1 1/2" NPT (42)	Pt 2" NPT (54)	Pt 2 1/2" NPT (70)	Pt 3" NPT (82)	Pt 4" NPT (104)	表面處理 Standard Fimistrs
A	34	35	35	49	59	65	67	115	151	鑄鐵電鍍鋅 Zinc Electroplate
B	14	18	24	32	38	48	75	96	106	
C	30	41	45	64	79	98	98	63	72	展性鑄鐵 熱浸鍍鋅 Zinc
D	49	50	51	70	81	90	99			

### 電纜出線接頭 CGS TYPE

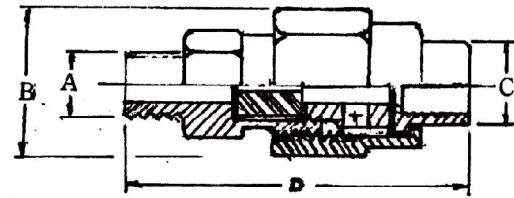
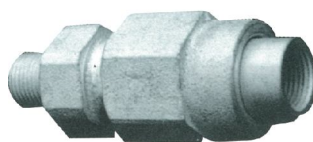

單位：mm

Cat No 目錄型號	CGS01	CGS02	CGS03							Cast Iron 鑄鐵
	CGS01-M	CGS02-M	CGS03-M							DACKTYL 展性鑄鐵
	CGS01-A	CGS02-A	CGS03-A							Aluminum 鋁合金
CONDUITSIZE 公稱管徑	Pt 1/2" NPT (16)	Pt 3/4" NPT (22)	Pt 1" NPT (28)	Pt 1 1/4" NPT (36)	Pt 1 1/2" NPT (42)	Pt 2" NPT (54)	Pt 2 1/2" NPT (70)	Pt 3" NPT (82)	Pt 4" NPT (104)	表面處理 Standard Fimistrs
A	21	21	33							鑄鐵電鍍鋅 Zinc Electroplate
B	45	45	59							
C	26	26	40							展性鑄鐵 熱浸鍍鋅 Zinc
D	110	110	119							